

AirBeast - Inflatable device instruction manual

Intended Use

AirBeast is intended for inflating Dunnage Airbag. AirBeast does not require an external air source.

Product Name

AirBeast

Parts

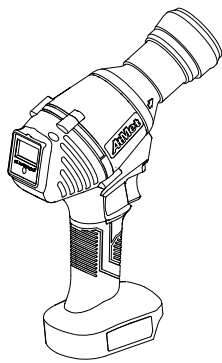

① Inflator x1

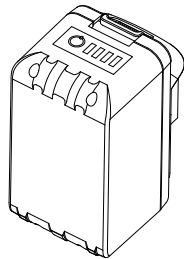

② Lithium Battery x1

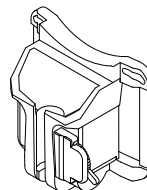

③ Buckle x1

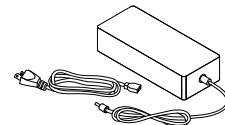

④ Charger x1

AirBeast Components

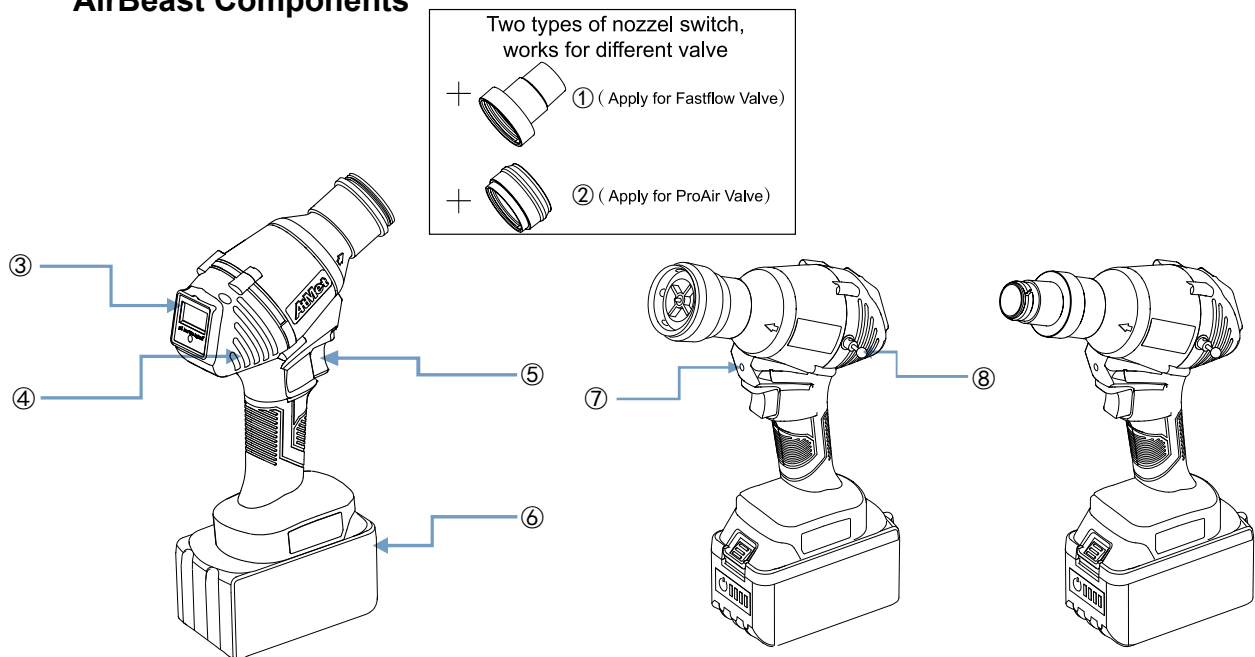

- ①: Fast flow nozzle ②: Proair nozzle ③: Lcd display ④: Air inlet ⑤: Switch ⑥: Lithium Battery
 ⑦: LED Light ⑧: Hook

Specifications

Product Weight(includes battery) (lbs)	Maximm air speed (m³/h)	Battery size/Amp Hours	Charge Time(hrs)
3.3lb	41	24V/5. 2Ah	4hrs

Inflation efficiency

Dunnage Airbag Size	Void	Time required to inflate to 1PSI (Sec)	Number of bags can be inflated per charge
32"x48"	8"	10	≈170
36"x48"	8"	12	≈140
48"x48"	8"	15	≈110
36"x66"	8"	17	≈95
40"x72"	8"	16	≈100
48"x84"	8"	29	≈55

Demonstration of strap through buckle

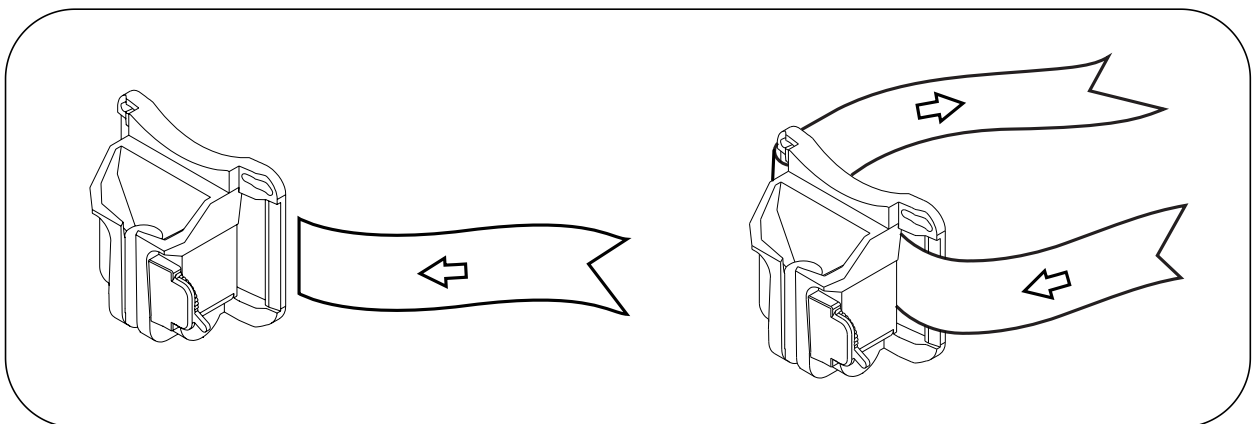

Demonstration of buckle in use

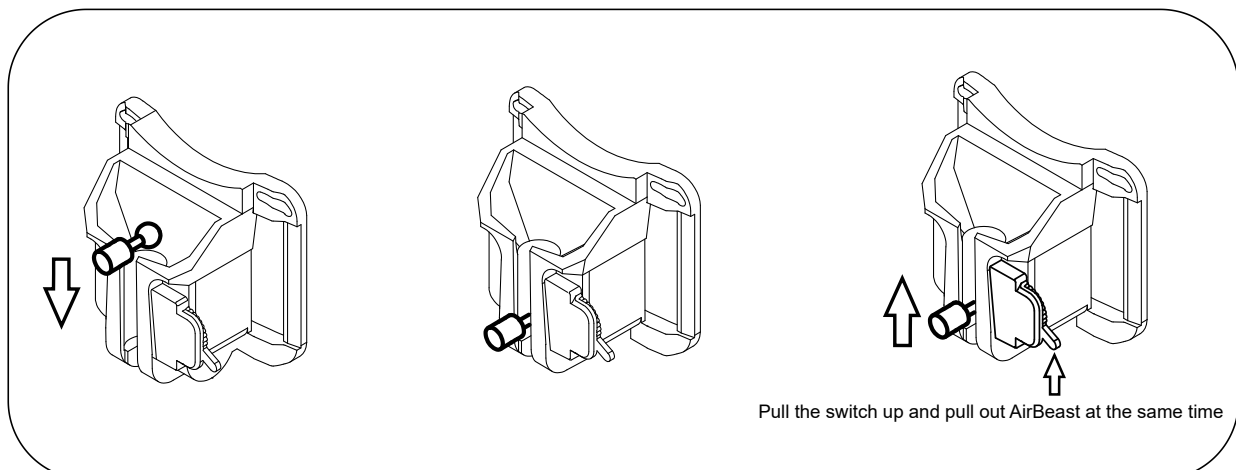

Pressure gauge display and unit adjustment

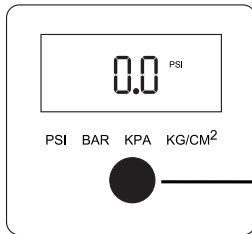

Turn on the switch, pressure gauges display function is turned on simultaneously, the pressure unit can be adjusted by the unit switch button on the display.

Unit switch button

Once you press ●, unit switches. As followed: PSI, BAR, KPA, KG/CM².

Installation and Instruction

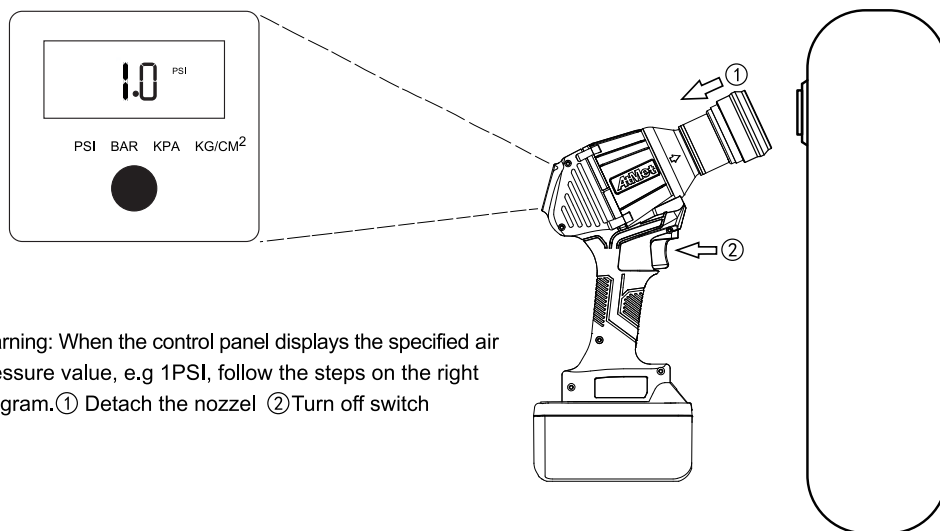
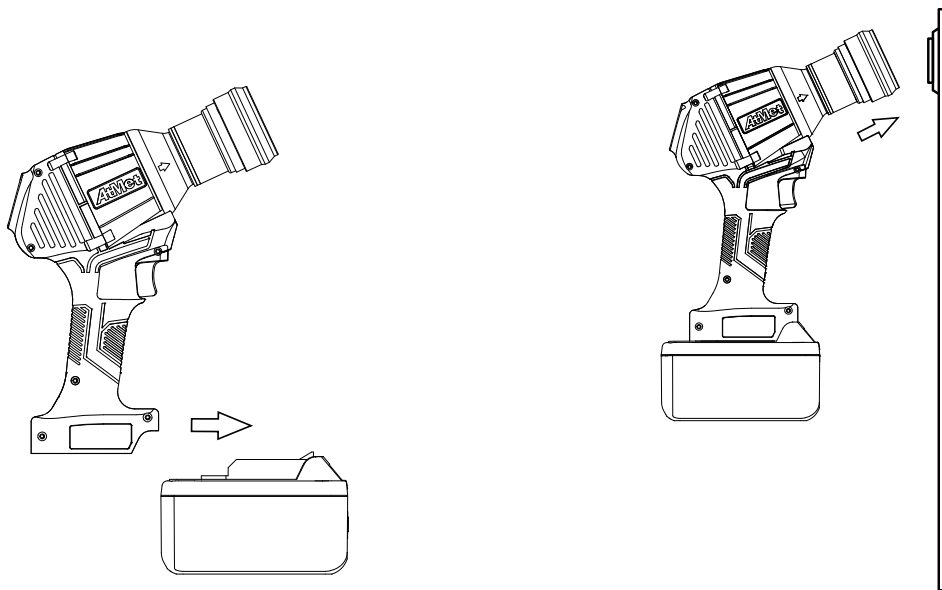

Warning: When the control panel displays the specified air pressure value, e.g 1PSI, follow the steps on the right diagram. ① Detach the nozzle ② Turn off switch

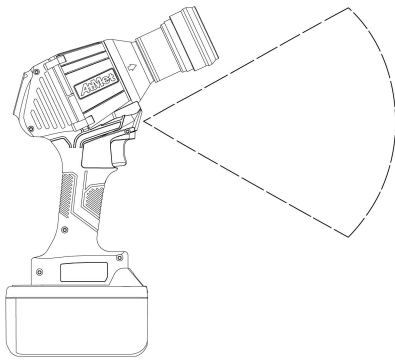

Lighting function

Turn on the inflator, and the lighting function will be turned on simultaneously.

Lithium battery power display

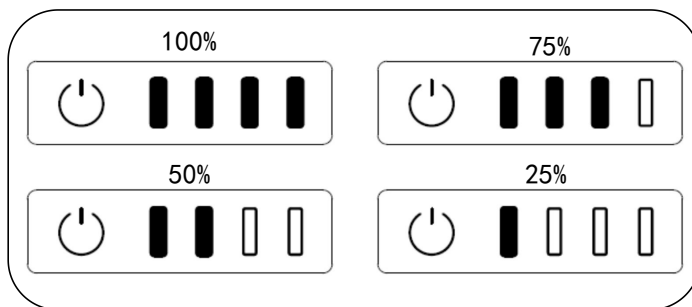

Lithium battery charging

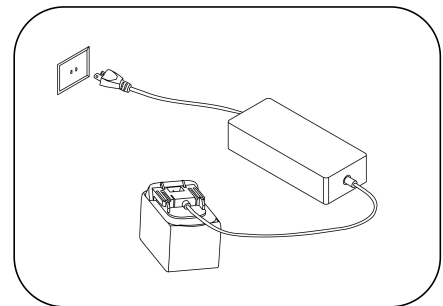

Precautions

1. Ensure that battery and inflator are properly connected before each use.
2. Lithium batteries need to be recharged regularly after long-term storage, Ensure that the battery level is not less than 50%; When the battery is low, it needs to charge in time; If the AirBeast is not used for a long time, the lithium battery should be removed to prevent the battery life from being shortened.
3. Do not operate your inflator in rainy environment to prevent device short circuit.
4. The air inlet of the inflator is open, can not be blocked during inflation to prevent the motor from burning out, also prevent debris from entering the case.
5. If a stall occurs during the inflation longer than 6 seconds, AirBeast will be shut off automatically to protect the motor.
6. When the device continues to work causing the motor or battery to overheat, run the machine without load for a while, utilize the rotation of the fuselage rotor blades, drive the air circulation inside the machine, in order to cool down the machine quickly.
7. Prevent falling and falling on hard ground to avoid damage the device.